

closomat®



OUR PRODUCTS AND SERVICES: 2021/2022

We believe that dignity and independence are fundamental to a person's well-being. And that everyone has the right to live their best life. We do our best to make that happen.



We help people live their best lives.

At Closomat, we believe that everyone has the right to live their best life, regardless of the challenges they face in their intimate toileting needs.

This guiding principle was instilled in us by our founder, Robert Willan. After seeing a “fancy throne” on a business trip to Switzerland, he was fascinated by the concept and saw what an impact it could have on personal hygiene. So, in 1962, he founded the company and became a Wash and Dry toilet pioneer.

Today, the Closomat Palma Vita is the biggest selling Wash and Dry toilet in the UK. We are trusted by people with intimate toileting needs, by their families and carers, by installers, by distributors and by medical and clinical professionals who choose us to help make a difference to the lives of the people who use our toilets, both in the home and away from it.

We never lose sight of the important role our products and services play in the lives of our customers and this drives us on in continuing to provide the highest quality products and the best possible customer care.

A handwritten signature in black ink, appearing to read 'B. Hoare'.

BRIAN HOARE
MANAGING DIRECTOR

VISION STATEMENT

- Ours is a **VISION** of a future where **INDEPENDENCE, DIGNITY** and **HYGIENE** is a part of everybody's life

MISSION STATEMENT

- It is our **MISSION** to supply innovative personal healthcare products, in and away from the home to all of our customers
- We do this by engaging with specialist solution providers across all sectors, combining their expertise with our own 60 years' worth of experience, resulting in the best outcome available
- We aim to achieve this by providing excellent customer service, market-leading product solutions and attentive ongoing support
- We will invest in the latest technology and in our people, whilst maintaining our core values – Quality, Innovation, People and Success
- We will remain committed to being a UK manufacturer



British design, manufacturing and quality.

We are the only specialist UK-based manufacturer of Wash and Dry toilets. Our head office and customer support centre in Manchester is the hub for a network that includes the UK's only purpose built Wash and Dry toilet product and assembly facilities, and a nationwide network of our own sales and service teams.

We manufacture our products in the North West of England and have done so for more than 60 years. We blend Swiss engineering excellence and high quality materials with British craftsmanship. The result is a range of products built to stand the test of time.



More than just a toilet.

Our products have been designed in consultation with healthcare professionals and have a range of clinical, health and well-being benefits.

We know that everyone is different, even if they have the same disability or condition. That's why we ensure our products are customisable in thousands of ways, so they can be the perfect solution for both simple and complex needs. And not just for what is needed now, but also for what may be required in the future.

One of the key benefits of our products is that they enable "single-handed care". This means that an individual can often go to the toilet unaided where, previously, they would have needed a partner or carer to assist them.

Customer care comes as standard.

We understand that our products provide a much valued level of independence, which is relied upon every single day. That's why they are built, in the UK, to stand the test of time.

And we support you and our products with our own customer service team, and our own service engineers, to ensure a consistent and expert backup service – from helping to specify the right product, to supporting a smooth installation, and providing a range of servicing and maintenance packages.

You can be assured that you are not only buying a product, but also the full backup and support from a manufacturer who understands how important our products are to users. This gives you the peace of mind of knowing that your toilet will be there for you now and into the future.



Wash and Dry Toilets. The highest level of personal hygiene.

What is a Wash and Dry Toilet?

Put simply, Wash and Dry toilets (sometimes referred to as “shower toilets”) combine the functions of a toilet, a bidet and a drier in one easy to use unit. The toilet flushes, washes the user with warm water, and finally dries with warm air.

Who can use a Wash and Dry Toilet?

Anyone! But they are of greatest benefit to people who may struggle wiping themselves with toilet tissue as they may lack the required manual, mental and physical dexterity, flexibility, and balance.

The nature of certain disabilities or medical conditions means that because some people are not able to wipe themselves, it can result in personal hygiene issues, higher risk of infection and an increased burden on family members or carers. This can, in turn, lead to psychological issues, feelings of isolation or reduced self worth from the loss of independence and dignity.

What are the benefits of Wash and Dry Toilets?

Whether the user is disabled or not, inevitably one is cleaned better with water than with toilet tissue. Furthermore, with hand/body contact removed the risk of infection or cross contamination through failure to wash hands is greatly reduced.

Clearly, the fundamental reason for Wash and Dry toilets is to effectively wash the anal area, but the additional personal and psychological benefits cannot be under-stated.



The Closomat Vita Range. The ultimate in Wash and Dry toilets.

Our Vita range is the culmination of over 60 years of innovation, development and refinement. We believe that it is the best Wash and Dry toilet range anywhere.

The heart of our toilets is the washing and drying experience: the most effective available in the UK. We promise a powerful, effective jet of warm water that allows for maximum suitability across a wide range of end-user requirements. Uniquely, our range of douche arms provide a vertical jet of water ensuring it is directed exactly where you need it.

Precisely machined from strong and rust-proof stainless steel, the spray arm is self-cleaning, and smoothly retracts into the porcelain pan when not in use. The warm water washing is followed by thorough warm air drying – so you are left with the ultimate feeling of cleanliness and freshness.

The Closomat Experience.

Built to stand the test of time

Advanced engineering, high-quality materials, careful craftsmanship and a design of timeless beauty that has been refined for more than 6 decades. All this creates what we like to call the Closomat experience. Behind it stands British craftsmanship and Swiss engineering for a better quality of life – day in, day out.

Unique comfort

You sit comfortably and upright. When you're ready, trigger the flush: the Wash and Dry toilet cleans you thoroughly and comfortably with warm water and dries you gently with warm air.

Feel truly clean

The powerful pump system and smooth spray are designed to ensure you are effectively cleaned to a consistently high standard, without cross contamination of body waste.

Unique, self-cleaning nozzle

The unique, self-cleaning system guarantees the highest standard of cleanliness.

One touch operation

Our toilets are easy to use. They provide hands-free cleaning. Stay seated and trigger the flushing, cleaning and drying process. It's that simple.

A refreshing and invigorating experience

Experience pure pleasure that will surprise and refresh you. It stimulates blood flow and cleans you perfectly and hygienically. It can stimulate bladder and bowel movement. Anyone who has experienced the feeling will not want to do without it.

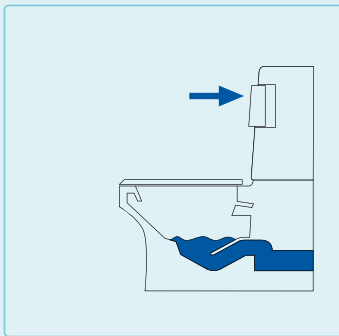

FLUSHING

Press either elbow pad whilst standing for conventional flush.



WASHING

Press elbow pad whilst seated and hold down for approximately 10 – 15 seconds. Flushing and warm water washing will then take place.

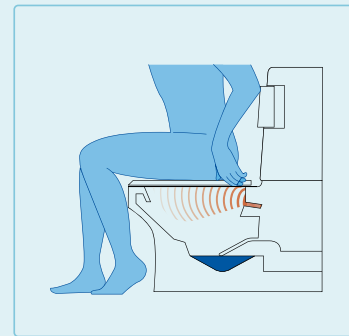

DRYING

Warm air drying automatically follows when elbow pad is released.

The Closomat Vita Range. Timeless design, completely flexible.

We're all about making things easier for the people who use our toilets, so that's why there are just two products in our range. Both products offer all the benefits of our wash and dry system, and both are infinitely customisable so they can be personalised to individual requirements. The only difference is that the Palma Vita is floor mounted and the Lima Vita is wall mounted.

Closomat Palma Vita

Definitive, classic, floor-standing system. The timeless design enjoys pure sleek lines. The Palma Vita can be easily personalised to suit individual needs. A full range of accessories, such as specialised seating, lifts and grab handles, can be specified at the installation stage, or added later as needs change. In fact, there are over 150,000 permutations, so you can be sure that even the most exacting requirements can be met.

BENEFITS OF THE PALMA VITA

- Closomat's unique system allows the user to benefit from the toilet's automatic functions by just pressing and releasing the elbow pad
- Easy to use regardless of manual capability/dexterity
- Removes hand/body contact and risk of faecal contamination
- Enables the user to go to the toilet with little or no help
- Can be used by all members of the household
- Safe working load: 190kg/30st

Bariatric Palma Vita (with Big John Seat)

- Safe working load: 362kg/57st



Closomat Lima Vita

Where timeless design and sophisticated engineering meet. The Lima Vita shares all of the features and benefits of the Palma Vita, but it has been specifically designed to be wall mounted. This gives you the flexibility to fix the unit at the exact height required, maximising comfort and practicality.

BENEFITS OF THE LIMA VITA

- Wall-hung version of the Palma Vita
- Enables unit to be fixed at exact height required by the user
- Ergonomically designed to properly support the user
- Ideally suited for underfloor heating
- Facilitates bathroom/wetroom floor cleaning
- Can be used as a conventional WC
- Safe working load: 190kg/30st



Customising your toileting experience.

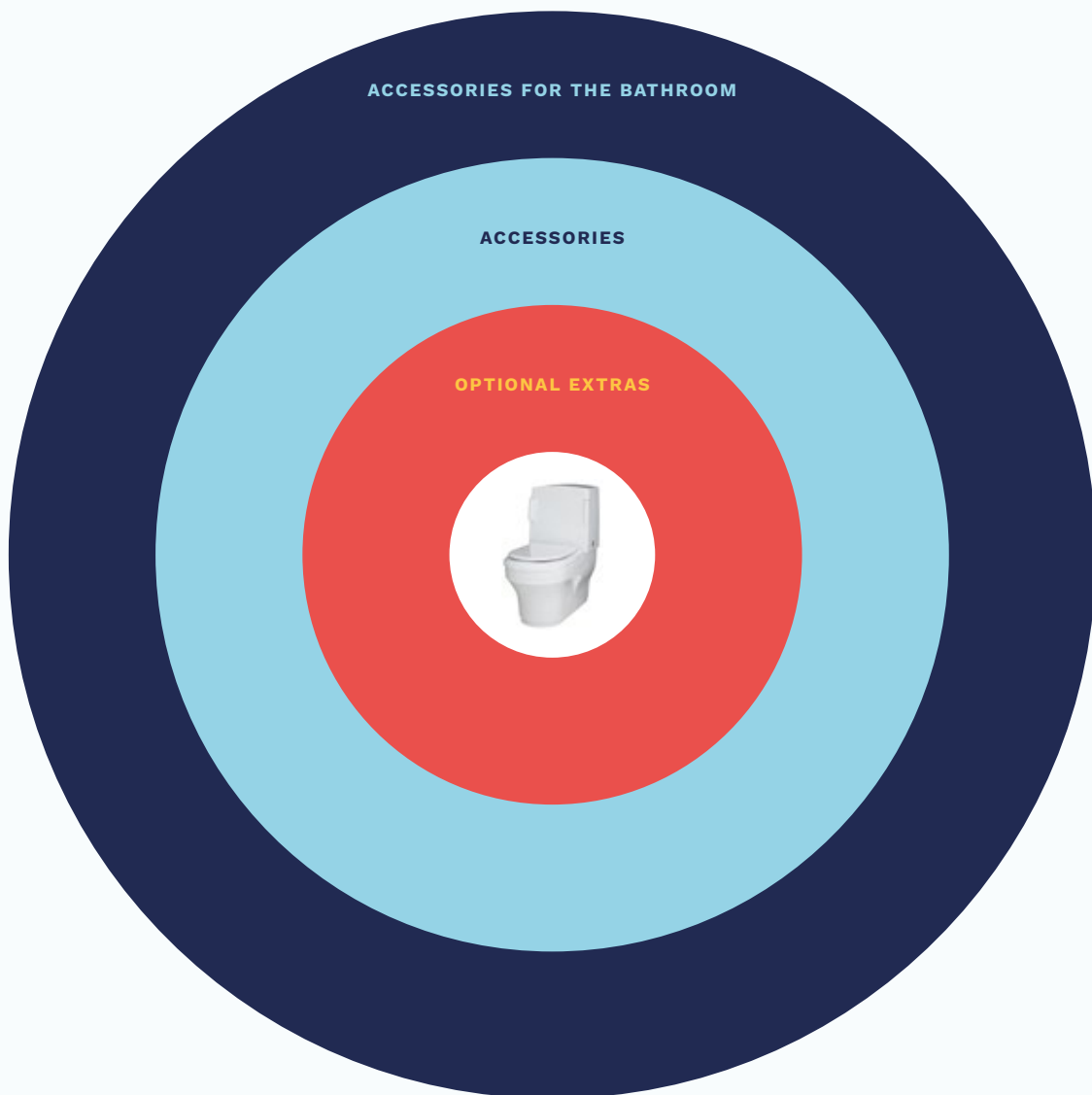

The Vita range is the product of over 60 years of innovation. Although it has been designed to work "out of the box", it can also be customised to cater for a range of needs – from the straightforward to the complex and challenging. In order to ensure the best possible toileting experience built around the user's individual needs, we have created a range of accessories and complementary products to ensure the best possible toileting experience. From controls to seating; from supports to products in the wider bathroom – everything is designed with the user's needs in mind.

Vita Range: Optional Extras

SEATING

PAGES 18 – 19

OPERATING MECHANISMS

PAGES 20 – 21

THE VITA SUPPORT RANGE

PAGES 22 – 23

We offer a selection of products that can be physically fixed to the toilet to further enhance your experience and ensure everything is tailored to your needs. This can range from the perfect seat to the most comfortable method of operation. Our optional extras can be fitted at the time of order or at any time in the future if your needs change.

Vita Range: Accessories

PAEDIATRIC SOLUTIONS

PAGES 24 – 25

BARIATRIC SOLUTIONS

PAGES 26 – 27

AEROLET TOILET LIFTS

PAGES 28 – 31

SHOWER CHAIRS

PAGES 32 – 33

Whether it's an Aerolet Toilet Lift, a Shower Chair or a Bariatric Seat, these complimentary accessories allow people with a very wide range of conditions to go to the toilet by themselves, giving them independence in the bathroom which they didn't think would be possible.

Vita Range: Accessories for the bathroom

HOISTING SOLUTIONS

PAGES 34 – 35

CHANGING BENCHES

PAGE 36

WASH HAND BASINS

PAGE 37

SHOWER LIFTS

PAGE 38

IDRY BODY DRYER

PAGE 39

Our six decades of experience in assisted toileting means that we understand that there are a very wide range of needs and conditions. Our Bathroom Accessories can provide a more holistic experience whatever the space. This means that one room can be adapted to cater for most disabled access requirements from hoisting to adult changing, as well as independent toileting. And we can supply a range of bathroom accessories for both domestic and commercial environments.

Accessories: Seating.

Are you sitting comfortably?

Sitting in the right position, and comfortably, encourages easier bladder and bowel movement.

Standard seat

Our standard white seat is ideal for most users. It is contoured and comfortable. It is very strong and has design features to stop lateral movement allowing for safer side transfers from wheelchairs (white plastic).

Junior soft seat

A smaller centre aperture ensures the child is properly supported over the pan without risk of buttocks slipping through the opening.

Adult soft seat

A standard sized seat with 'soft feel' to optimise comfort.

Adult Open Fronted soft seat

The open front improves hygiene. It reduces surface area for potential urinary 'splashback'. It enables a male to accommodate his anatomy more comfortably. It facilitates effective wiping (if chosen over douching) for a female.

Bariatric 'Big John' seat

With its wider sitting area, this seat gives appropriate, comfortable buttock support for the larger user (white plastic).



STANDARD SEAT



ADULT SOFT SEAT



JUNIOR SOFT SEAT



ADULT OPEN-FRONTED SOFT SEAT



BARIATRIC 'BIG JOHN' SEAT

Accessories: Operating Mechanisms.

Closomat Wash and Dry toilets are personalised to individual requirements.

Everyone is different with different needs. That is why we aim to provide the most versatile set of options with our toilets, meaning that they can be operated by almost anyone or their carer.

Touch Sensitive Hand/Foot Switch

This device is for those users who are unable to use the standard elbow pads. Air operated, no electricity is required to operate it, only very light pressure.

Proxy Switch

Making use of 'passive technology' the Closomat Proxy Switch allows users with little or no grip to activate the unit, simply by passing their hand/body-part in front of the sensor.

Infrared Remote Control

This simplistic 'one button' style Infrared Control provides a versatile option lending itself particularly well when used by carers.

Plinth

Plinths are used to raise the whole unit. For use with a shower chair or to aid direct wheelchair transfer. Plinths come in heights of 25mm, 50mm, 75mm and 100mm.

Infill Panel

The Infill Panel has been designed to aid installations where pipe-work inhibits the Palma Vita from being located against the wall. The Infill Panel is available in thickness sizes 25mm, 50mm, and 75mm. The Infill Panel is 100mm taller than the Palma Vita. It must be cut from the bottom to suit finished toilet height.



TOUCH SENSITIVE HAND/FOOT SWITCH



INFRARED REMOTE CONTROL



PROXY SWITCH



PLINTH



INFILL PANEL

Accessories: The Vita Support Range.

With slips, trips and falls mainly occurring in the bathroom, it's important to us that going to the toilet is above all safe and stress free. That's why we have created a support system that can be used daily and adapted in the future.

Integrated Fold-Down Support Arms

Robust and secure support arms designed and manufactured specifically for the Closomat. This convenient support system not only folds out of the way to aid side transfer from a wheelchair, it also has a number of additions that can further aid the user's stability. A lap strap is also available. Integrated Fold-Down Support Arms are ideal for installations where wall construction is poor.

Soft Arm Sleeves

Easy to fit, the Soft Arm Sleeves provide a comfortable, hygienic and stylish dimension to the Integrated Fold-Down Support Arms.

Lateral Body Supports

These easily adjustable and comfortable additions help to provide extra support and stability to the user, in conjunction with the Integrated Fold-Down Support Arms.



INTEGRATED FOLD-DOWN ARMS



SOFT ARM SLEEVES



LATERAL BODY SUPPORTS

Paediatric Hygiene and Toileting: Rifton HTS (Hygiene Toileting System)

Arguably the most versatile and cost-effective solution in paediatric toileting today, the Rifton HTS is fully compatible with the Vita Range of Wash and Dry toilets. Available in either a robust 'tilt-in-space' shower/commode chair or a 'clip-on' seat, both of which are versatile and adaptable via its use of easy-adjustment and large range of accessories.

The result is a hygienic and dignified toilet experience for your young person.

Rollover

- Medium and large sizes¹
- Secure fittings from 'head to toe'
- Range of accessories for optimum tailoring to individual requirements
- Compatible with Closomat Palma Vita (single extended douche required)
- Medium safe working load: 68kg/10.7st
- Large safe working load: 113kg/17.7st

Please note

Either the Touch Sensitive Hand Switch (TSHS), Remote Control, or the Proxy Switch is required when using a Rifton HTS.



FULL RIFTON



TSHS



PROXY SWITCH



REMOTE CONTROL

Clip-on

- Bespoke bracket system to clip onto/off the Palma Vita²
- Enables use of the footboard without the whole chassis
- Can be clipped on and off as required
- Enables appropriate support for the child, with the flexibility for the Palma Vita to be used by other members of the household
- No need to remove the Palma Vita seat
- Compatible with Closomat Palma Vita (single extended douche required)
- Medium size only
- Safe working load: 68kg/10.7st

The following items are always required when ordering the HTS Clip-on:

- Bespoke Bracket
- Soft Seat
- Touch Sensitive Hand/Foot Switch, Proxy Switch, or Remote Control



HALF RIFTON



BESPOKE BRACKET

Options



SEAT AND BACK PADS



HEADREST



BUTTERFLY HARNESS



ANTERIOR SUPPORT/TRAY



LATERAL SUPPORTS



LATERAL SUPPORTS
AND CHEST STRAP



FOOTBOARD



HIP GUIDES



ABDUCTOR



CALFREST AND
ANKLE STRAPS

¹ Please note that the Small HTS is not compatible with the Palma Vita.

² When the Bespoke Bracket is fitted to the Palma Vita the Rollover version cannot be used.

Bariatric Toileting: Big John Seat

Bariatric Palma Vita

The Bariatric Palma Vita brings together all the proven benefits of our market-leading Wash and Dry toilet with the added advantage of being able to accommodate up to 57 stone – making this the only bariatric Wash and Dry toilet.

Making use of the patented Big John Seat, the Bariatric Palma Vita is engineered for long-lasting durability. The stylish design has a more comfortable, contoured opening to the seat offering greater stability, comfort, safety and is purpose-designed to correctly position the user for an effective clean.

- Wide, contoured seat
- Made from high-impact ABS that is both stain and chemical resistant
- Durable, stainless steel hinges
- Non-slip bumpers
- Delivers a consistent, high level of cleanliness
- Safe working load: 362kg/57st



PALMA VITA WITH BIG JOHN SEAT



BIG JOHN SEAT

Bariatric Toileting: Aerolet Lift & Closomat Bench

Bariatric Aerolet (Tilting)

The electronically-controlled lift gently and securely raises and lowers the user over the toilet whilst they remain fully seated, supported and in control.

- Offers perfect support for bariatric users
- Supplied with ergonomic seat specifically designed for heavy users
- Big John toilet seat
- Only tilt version available
- Safe working load: 250kg/39st

Full Aerolet Range available (see next page).



AEROLET BARIATRIC

Closomat Bench

The Closomat Bench is a semi-bespoke solution for those residents that require a seating area typically greater than a conventional toilet seat.

Made from similar materials to that of a shower/commode chair, the Closomat Bench provides a more comfortable seat allowing for residents with a larger body-mass to sit for longer safely.

- Powder-coated, tubular stainless steel frame
- Vinyl covered seat
- Non-slip rubber feet
- Optional armrests
- Seat aperture; normal or horseshoe
- Standard working load: 349kg/55st¹



CLOSOMAT BENCH

¹ Benches to a higher capacity available on request.

Aerolet Toilet Lifts: Vertical/Tilt

Aerolet Toilet Lifts are the bathroom equivalent of a rise/recline armchair.

Supplied in either 'tilting' or 'vertical' action, a Toilet Lift reduces a resident's risk of falls and injuries, enhances their dignity and independence, and decreases reliance on carers. It does this by replicating the natural motion of standing up and sitting down. Gently raising and lowering the user accurately into position over the toilet as required whilst enabling their feet to remain in contact with the floor, maintaining balance.

Aerolet Vertical or Tilt

- Closomat Palma Vita compatible
- Range of seat options available
- Seat-seal on underside of Aerolet ensures optimum drying
- Aerolet fixes to Palma Vita
- Aerolet depresses seat-pins on Palma Vita providing washing & drying functions
- Please note that the Palma Vita compatible Aerolet can be converted for use with a conventional toilet via a bespoke bracket at an additional cost
- Both models have a safe working load of 150kg/24st



AEROLET VERTICAL LIFT

Suits people with good upper body strength. It's integral support arms raise and lower with the seat, as the lift lowers and raises the user whilst giving them the control to lever themselves down on to, or up from, the unit.



AEROLET TILT LIFT

Is appropriate for people with strength in, and control over, their legs and knees. The user simply leans against the seat, holding the fixed support arms and bearing their weight on their legs as they operate the unit as it moves them from/ to the vertical.



PALMA VITA WITH AEROLET TILT

Both versions can be used with the Closomat Vita Range as well as a conventional toilet.* Safe working load: 150kg/24st.

*Conventional Aerolet Toilet Lifts are made to order.

Aerolet: Conventional



AEROLET CONVENTIONAL

Fits most bathrooms and most standard WCs, be they traditional floor-mounted, or wall-hanging.

- Fits most existing bathrooms
- Height-adjustable
- Can be supplied with different types of toilet seats
- All Aerolet toilet lift models can be fitted with optional fold-away arm supports for easier user transfer
- Safe working load: 150kg/24st



AEROLET SMALL

For use in bathrooms and toilets where space is more restricted. As its standard counterpart, it can be adjusted to accommodate bowls set at different heights, or hanging systems.

- Fits most existing bathrooms
- Height-adjustable
- Can be supplied with different types of toilet seats
- Can be supplied with fold-away arm supports for easier transfer (optional)
- Safe working load: 150kg/24st

Toilet Lift: Accessories



AEROLET LIFT CONTROL

UP/DOWN BUTTONS CAN BE MOUNTED ON THE LEFT OR RIGHT SIDE.



MODEL 24V

WHERE A POWER POINT IS UNAVAILABLE/CANNOT BE INSTALLED.



SEPARATE HAND CONTROL

FOR USE IF THE AEROLET IS USED WITHOUT ARM SUPPORTS, AND/OR IF THE USER HAS LIMITED HAND AND/OR FINGER FUNCTION.



WATERTIGHT SHOWERLIFT CONTROL

CAN BE MOUNTED ON EITHER SUPPORT ARM. FOR AEROLET SHOWERLIFTS, SEE PAGE 38.



FOLD-AWAY ARM SUPPORTS

ALL AEROLETS CAN BE FITTED WITH FOLD-AWAY RATHER THAN FIXED ARM SUPPORTS TO EASE USER TRANSFER.



MOVABLE ARM SUPPORTS (COW-HORN ARMS)

PROVIDE EXTRA SUPPORT DURING LIFTING.

Seating: Soft Seats

Options available are Junior, Adult and Adult Open-fronted. All soft seats are supplied in a dark blue colour to aid the visually impaired.



JUNIOR SOFT SEAT



ADULT SOFT SEAT



ADULT OPEN-FRONTED SOFT SEAT

Shower Chairs: Palma Vita Compatible

Shower Chairs

Closomat compatible shower chairs provide the resident with the versatility of a traditional shower chair but with the added benefit of working seamlessly with the Vita Range, without compromising the effectiveness of the wash and dry.

Chiltern AquaMaster Range (A06C & A11C)

The AquaMaster is height-adjustable,* so it, rather than the toilet, is set to the height required by the user. It can be converted from self-propelled (A11C) to carer-assisted (A06C), and vice versa, as the user's needs change.



A06C

*Spacers required, making it compatible with a Palma Vita installed with 25mm plinth, or 50mm plinth.



A11C

The AquaMaster is fitted with:

- Pram handles
- Integrated skirt surrounding aperture
- Full ring aperture or Horseshoe seat
- Adjustable footrests
- Height-adjustable
- Safe working load: 200kg/31st
- For added flexibility, the AquaMaster shower chair comes in three seat widths, 17", 19" and 21", which must be stated when ordering



PRISM T40

Prism Auto Range (T40 & T70)

The Prism Auto Range of shower chairs are based on the traditional model of shower/commode chairs but with specific design features making it complement the Vita Range in every way.

The T40 Auto is carer-assisted and the T70 Auto is self-propelled.

Both chairs are fitted with, as standard:

- Pram handles
- Integrated skirt surrounding aperture
- Horseshoe seat*
- Adjustable footrests
- Safe working load: 200kg/31st
- For added flexibility, the Auto range of chairs comes in three seat widths, 17", 19" and 21", which must be stated when ordering

*Full aperture available on request.

Accessible Bathrooms



A ceiling track hoist system allows carers to easily transfer clients from one location to another with improved safety for both. It's a flexible system that can be designed specifically for the client's needs and installed into most situations. The system's carry bar accepts the most universally used sling types.

The following options are available on selected models:

- Full room coverage
- Can be installed into most environments
- Easy and safe to operate
- Can pick client up from the floor
- "Soft start/soft stop"
- Remote control
- Rechargeable batteries
- Emergency lowering
- Safe working load: 200kg/31st

Ceiling Track Hoists: Likorall

Likorall hoist systems are versatile and robust, designed to be installed in almost any domestic or commercial setting making use of the range of mounting options.

As well as being easy to install, they are particularly simple to operate too. Features such as 'floor pick-ups', 'emergency lowering' and 'remote controls' make Likorall a brand leader.

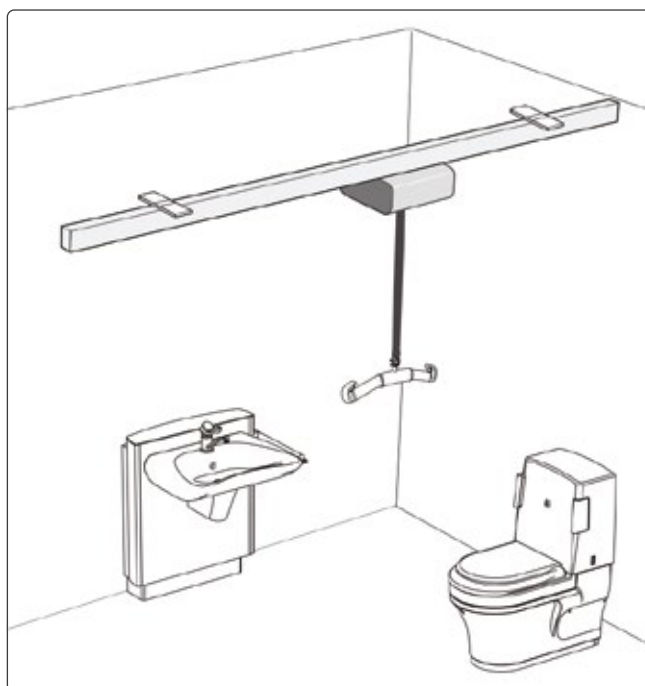

STRAIGHT-TRACK

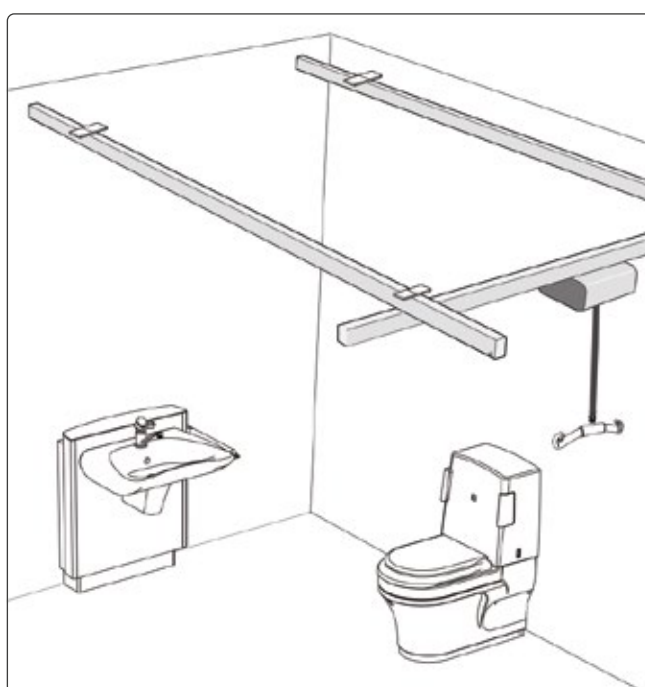

X/Y OR H FRAME

Changing Benches:

Wall mounted/mobile



Pressalit height adjustable adult-sized changing bench.

A wall-mounted height adjustable changing bench is suitable for most wetroom environments and used by multiple carers of different sizes and abilities.

Providing a large, comfortable lying area, which is easily adjusted for each carer to safely wash and/or change their client. Once finished, the bench can then be folded back against the wall to save space.

Pressalit's Changing Benches are operated via a tethered easy-to-use hand control and come with a fold-down safety rail for added peace of mind.

- Height adjustable
- Curved bench for user comfort
- Integrated water collection tray

- Safety rail easily positioned with one hand
- Can be folded against the wall when not in use, reducing space requirement
- Safe working load: 200kg/31st

Height adjustable mobile changing bench.

Easily moved, a mobile changing bench is ideal when multiple carers are required to tend to a client at the same time. The mobile changing bench is available in either electric or hydraulic action.

- Electric or hydraulic height adjustability
- Padded liner with head support
- Allows access from both sides
- Larger than wall-mounted, so requires more space
- Adjustable back-rest
- Safety rail
- Variable weight limits: 190kg/29st



MODEL SHOWN IS ELECTRIC

Height Adjustable Wash-hand Basin



Pressalit height adjustable wash-hand basin.

Height adjustable wash hand basins allow both wheelchair and ambulant users to enjoy the same wash hand basin safely and comfortably.

The numerous height adjustment options are available for basins requiring just occasional height change (manual), to those needing frequent daily changes (electric or gas). Aesthetically pleasing, the basin units sit well in most bathroom settings.

Safe working load: 100kg/15st

Aerolet: Shower Lifts

Aerolet Shower Lifts provide a safe and practical solution for those residents that need to be seated when showered.



TILTING SHOWER SEAT

The tilting version allows the resident to go from a standing to a seated position at their own pace.

- Integrated support arms
- Adjustable tilt pitch
- Safe to use in a shower area
- Safe working load: 150kg/24st

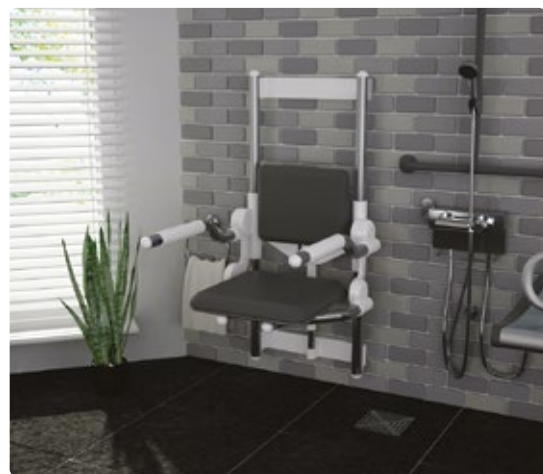

VERTICAL SHOWER SEAT

The vertical version is ideal for those residents that need to transfer from a wheelchair.

- Enable easy transfer from wheelchair into shower
- Folds away against the wall when not in use
- Fold-away arm supports
- Fold-up seat
- Electrically-operated
- Safe working load: 125kg/19st

iDry Body Dryer



The iDry Body Dryer is ideal for people with limited mobility or sensitive skin: after showering, they simply stand or sit in front of it as its gentle warm air jets dry the body without the abrasion of towel-drying.

Easy to install, the dryer's trunking can be cut to size making it ideal for use within an enclosed environment, which will aid the warm air to dry the resident more effectively.

- 70°F (20°C) air average
- Two-speed control
- Control can be positioned on floor or wall
- Can be fitted within the shower
- Costs no more than laundering towels

**Technical data
and service
requirements.**

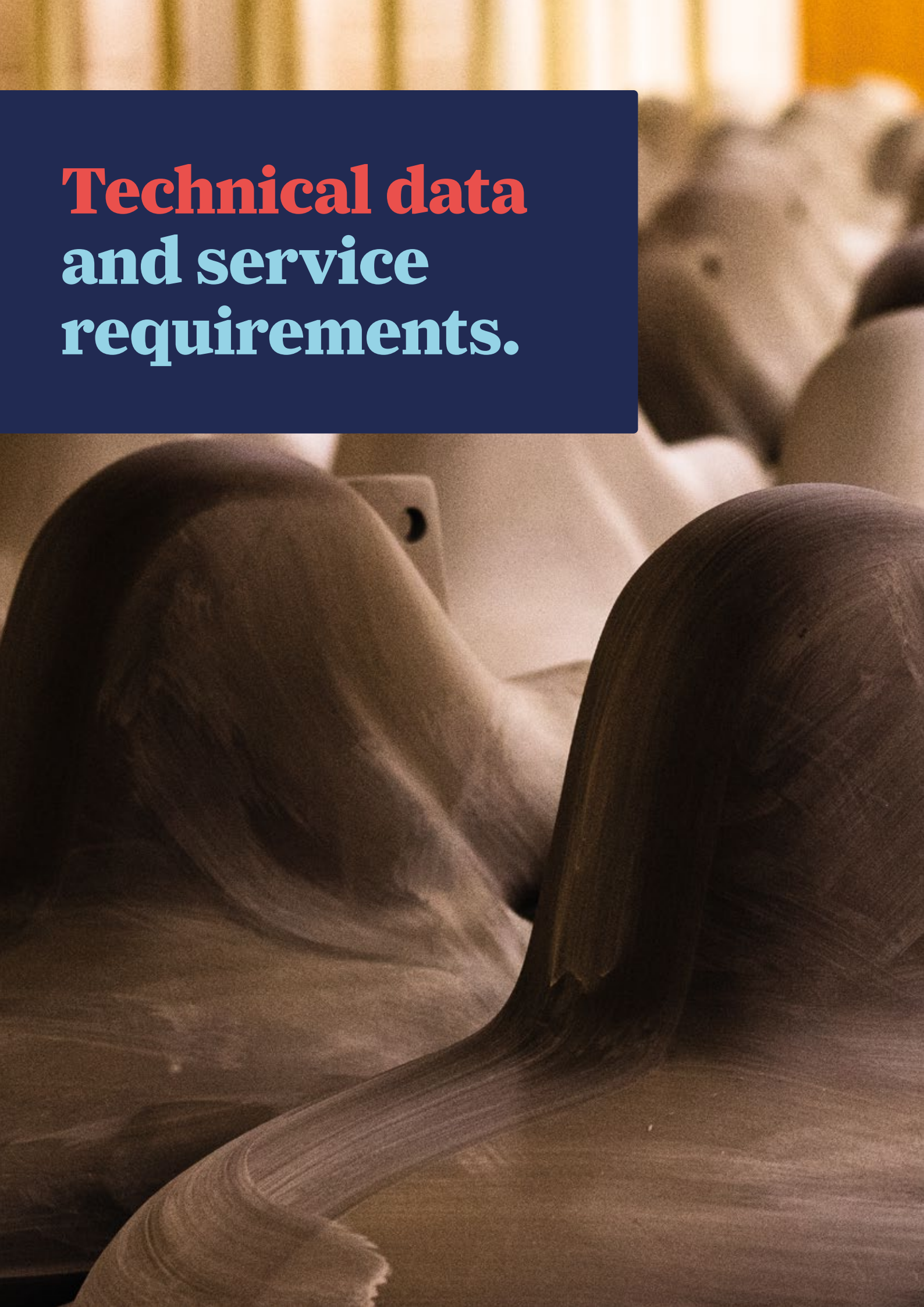



Vita Range Technical Data

The Closomat toilet must be installed by a competent or qualified person.

EXPLANATION OF SYMBOLS

- Safety instructions in this manual are identified by symbols. The safety instructions are introduced by signal words, which express the extent of the hazard/risk.
- In order to prevent accidents, personal injury, property damage and guarantee maximum user safety, follow the safety instructions without fail and exercise caution.

DESCRIPTION OF EQUIPMENT

- The Closomat toilet is an electrically operated shower (Wash and Dry) toilet designed to provide the operator/user with a hygienic solution to toileting.

START-UP PROCEDURE

- To enable a warm washing cycle operation the Closomat toilet must be switched on. Each Closomat toilet has its own isolation switch. To switch the unit on, locate the switch on the right hand side of the unit at the base of the cistern cover, through a Perspex screen.
- Once switched on, the water will reach core temperature within 5 minutes. It is advised that to maintain core temperature in readiness for use, the unit be left switched on at all times.

ELECTRICAL SERVICES

- To avoid the risk of electric shock, this equipment must only be connected to a supply mains with protective earthing by a competent or qualified person.

Mains Isolation

- All electrical appliances must be installed in accordance to the relevant regulations associated with the country it is within. To conduct any form of repairs or servicing it is recommended that a mains isolation device be located in the vicinity of the unit.
- 220–240V single phase AC supply is required (loading 4.5A–4.9A, maximum power 1300 watts). The Closomat toilet is supplied with a 3 core cable attached and must not be removed or replaced. A 10A fused spur is required for isolation.
- Spur outlet to be located in accordance with current I.E.E. Regulations (Current Edition).
- No modification of this unit is allowed other than by the manufacturer.
- **Closomat has IPX4 rating**

SHUTDOWN PROCEDURE

- For normal isolation, the Closomat toilet can be turned off using the integrated switch. To carry out any servicing, the unit **must** be isolated at the mains feed.

BATHROOM/SHOWER ROOM INSTALLATIONS

- The Closomat toilet must not be in direct line with the shower spray. Some form of partition between shower and the Closomat toilet is advisable to prevent any water spraying directly onto the equipment.
- A shower could not be used in conjunction with the Closomat toilet – i.e. under no circumstances must a user shower whilst seated on the Closomat toilet.

WATER SERVICES (WRAS APPROVED)

- **It is essential that the entering water is cold.**
- We would recommend water supply isolated via isolation valve.
- Water supply can be from storage vessel or mains (**'Grey Water' must not be used**).
- Boiler capacity: 1.7 litres.
- Water rate: Minimum: 8 L/minute
Maximum: 0.8 MPa (8 bar)
- Cistern capacity: 6 litres

OVERFLOW

- The Closomat toilet has an internal overflow which discharges into the W.C. pan through the flush valve.

SOIL CONNECTION

- Relevant soil connector to be sourced by installer.
- Soil connections suitable for Closomat toilet;
S-Trap (vertical fall) wall to centre of pipe from 70mm – 230mm max.
P-Trap (horizontal) floor to centre of pipe 200mm max.
- The Closomat toilet is suitable for all turned trap outlets, through purpose-made, removable side covers on lower level.

Palma Vita planning data and service requirements

Key/Installation guide:

W Water Services

Supplied with 15mm stainless steel braided outer, EDM inner WRAS approved flexible hose completed with integral isolation valve. (Please refer to page 42, water services prior to installation).

E Electrical Services

Supplied with 1000mm long, three core (live/neutral/earth) insulated 3183Y-I-white control flex-cable, rated to 220V/240V, 10 amps. (Please refer to page 42, electrical services prior to installation).

S Waste Details

Pan has a horizontal spigot standard 100mm diameter outlet, suitable for standard pan connection fittings.

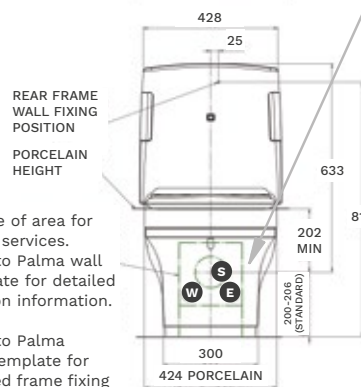
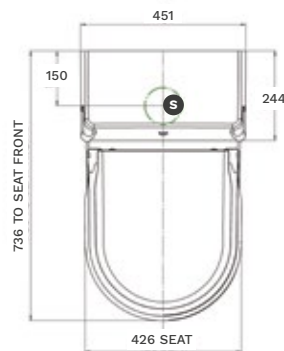
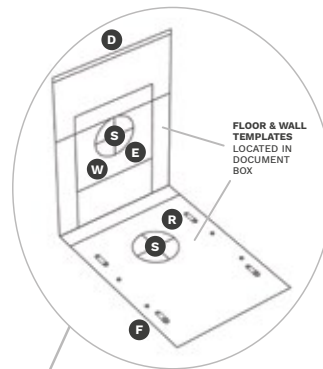

W Outline of area for Palma services. Refer to Palma wall template for detailed position information.

J Refer to Palma floor template for detailed frame fixing information.

D Rear Wall Fixing

Position 25mm to RH of the centreline. 810mm from the floor.

R Rear Floor Fixing (2No)

(Standard Installations) Position on the floor 102mm from the rear wall. 119.5mm to each side of the centreline.

F Front Floor Fixing (2No)

(When using Support Arms) Position on the floor 327mm from the rear wall. 119.5mm to each side of the centreline.

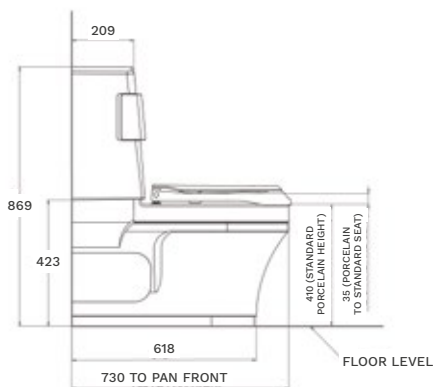

Lima Vita planning data and service requirements

Key/Installation guide:

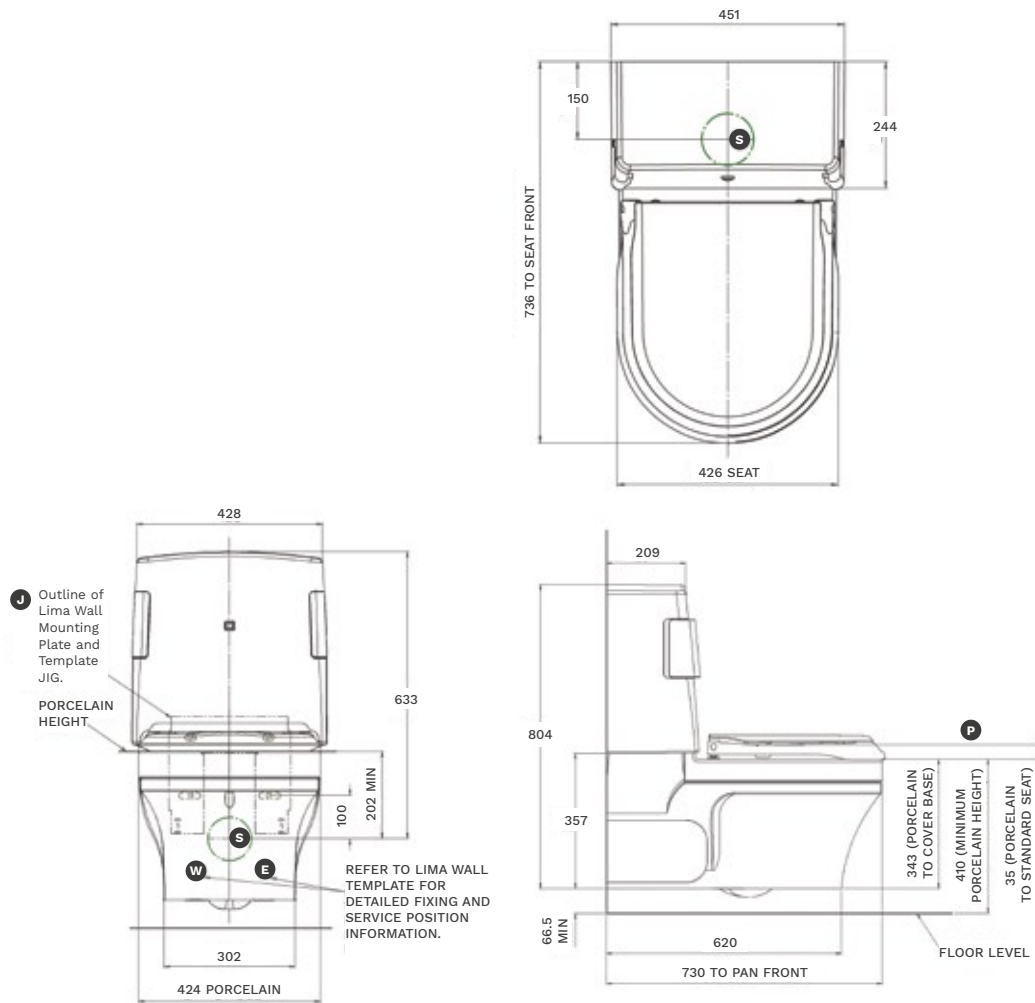

FURTHER NOTES

- No permanent hand rails or other obstructions should be fitted across the front or top of the unit. The outer casing has to be pulled upwards and forward to remove for servicing purposes.
- Unit not rated for altitude. 2000m is the maximum.
- This application requires an earth connection.
- Environmental conditions – operating ambient room temperature maximum = 40°C.

ENVIRONMENTAL CONDITIONS

- The Closomat toilet is rated to IPX4 and can be installed and operated within a typical shower/toilet room.

INFILL PANEL

- The Infill Panel is for Palma Vita only.

CLASSIFICATION

- Low Voltage Directive BS EN 60335-2-84.

CLEANING INFORMATION

- The use of bleach products is not advised due to the exposed stainless metal parts associated with the washing device (tarnishing may occur).
- The Closomat toilet washing device is designed to self cleanse during and after every use. Normal cleansing of the bowl and outer covers is required.

MAINTENANCE AND FREQUENCY OF SERVICEABLE PARTS

- The Closomat toilet is self-sufficient but it is recommended that a competent, experienced Service Engineer carry out a safety check and an annual service of the internal workings, to extend the Closomat's life.

RISK ASSOCIATED WITH THE WASTE OF EQUIPMENT AFTER SERVICE LIFE

- At the stage the unit is not repairable, it can be discarded to any appropriate recyclable plant. There are no immediate risks to the environment.

User guide

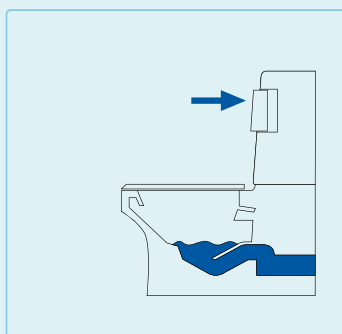

FLUSHING

Press either elbow pad whilst standing for conventional flush.



WASHING

Press elbow pad whilst seated and hold down for approximately 10 – 15 seconds. Flushing and warm water washing will then take place.

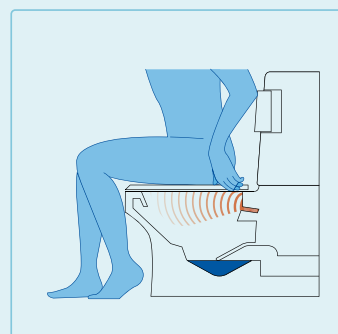

DRYING

Warm air drying automatically follows when elbow pad is released.

Wash and Dry

Douche options

Closomat douche showing three positions.

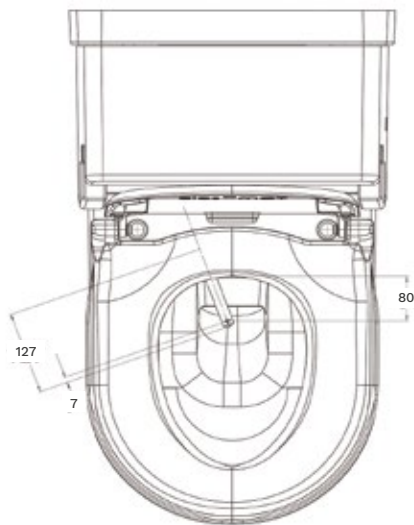

STANDARD
DOUCHE OPTION PLAN ON UNIT
DIMENSIONS APPROXIMATE

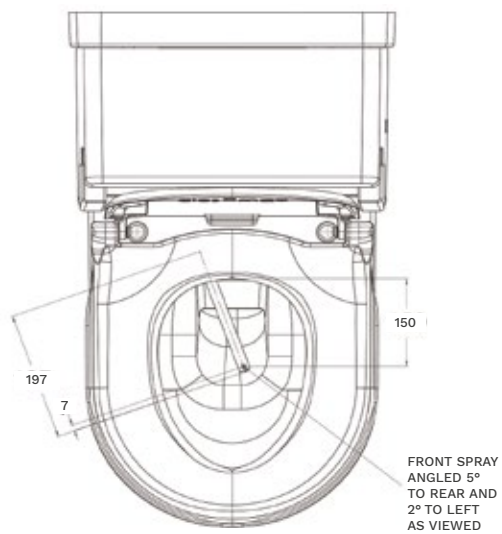

SINGLE EXTENDED
DOUCHE OPTION PLAN ON UNIT
DIMENSIONS APPROXIMATE

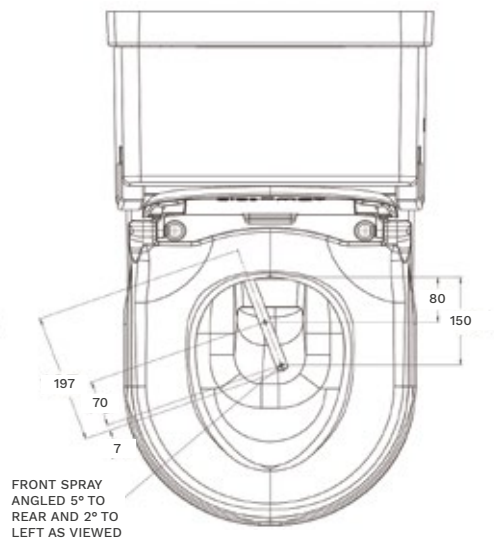

DOUBLE EXTENDED
DOUCHE OPTION PLAN ON UNIT
DIMENSIONS APPROXIMATE

Wash and Dry

Toilet Seat options

STANDARD SEAT PALMA SEAT (WHITE PLASTIC) SIDE AND 3D VIEWS SHOWN WITH LID (WHITE)	
ADULT SOFT SEAT PALMA SEAT (BLUE) SIDE AND 3D VIEWS SHOWN WITH LID (WHITE)	
JUNIOR SOFT SEAT PALMA SEAT (BLUE) SIDE AND 3D VIEWS SHOWN WITH LID (WHITE)	
ADULT OPEN-FRONTED SOFT SEAT PALMA SEAT (BLUE) SIDE AND 3D VIEWS SHOWN WITH LID (WHITE)	

Fold-down Support Arms

Palma Vita integrated Fold-down Support Arms technical data.

IMPORTANT NOTE

SUPPORTING ARMS MAY BE FITTED TO A CLOSMAT.

FLOOR FIXING INTEGRITY IS ESSENTIAL FOR THE STABILITY OF UNITS.

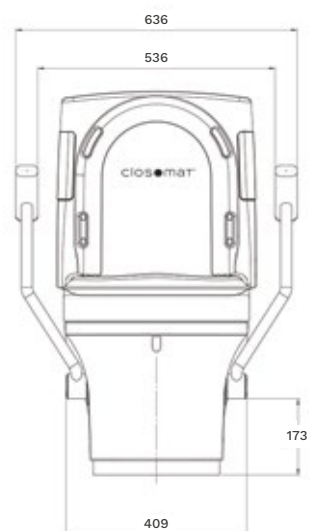
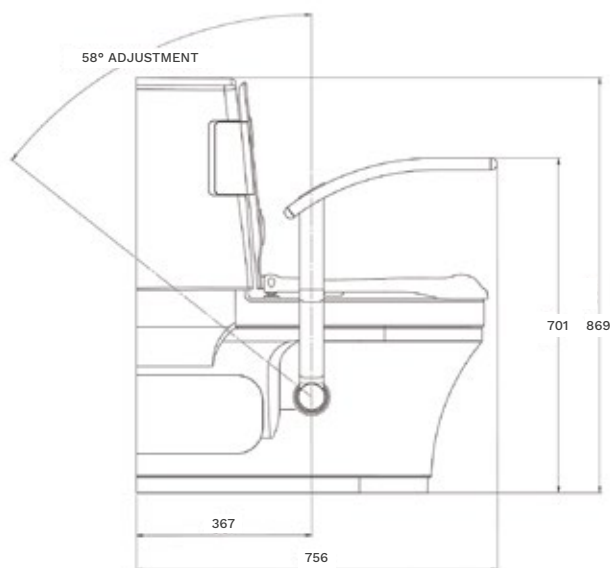
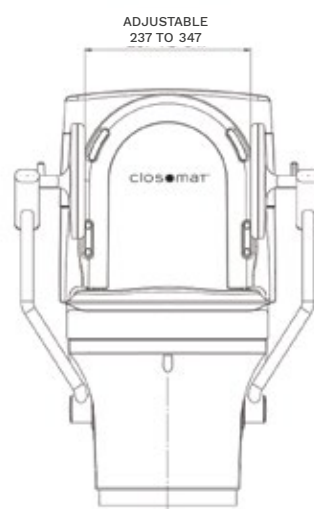
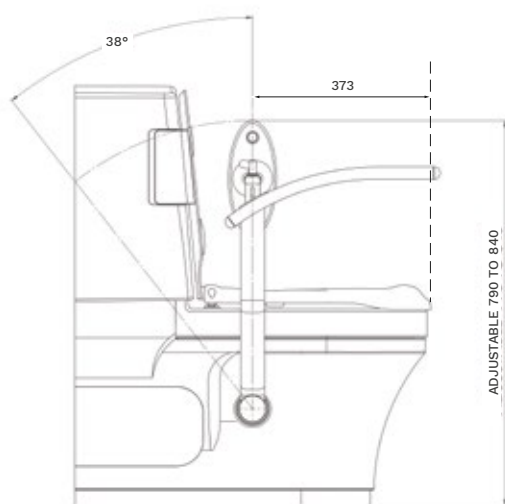

How to drill holes in the cover if armrests are fitted.

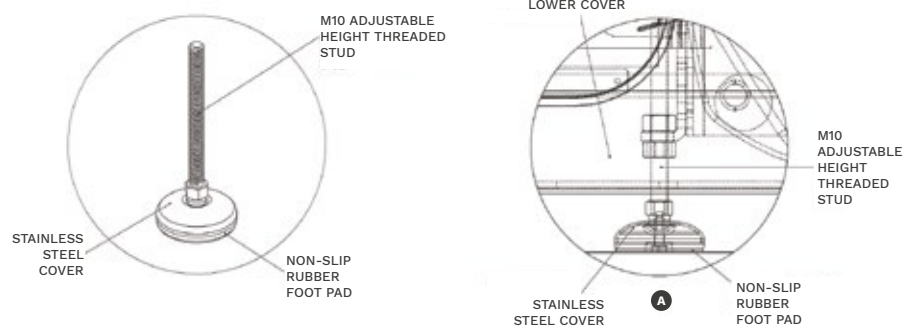
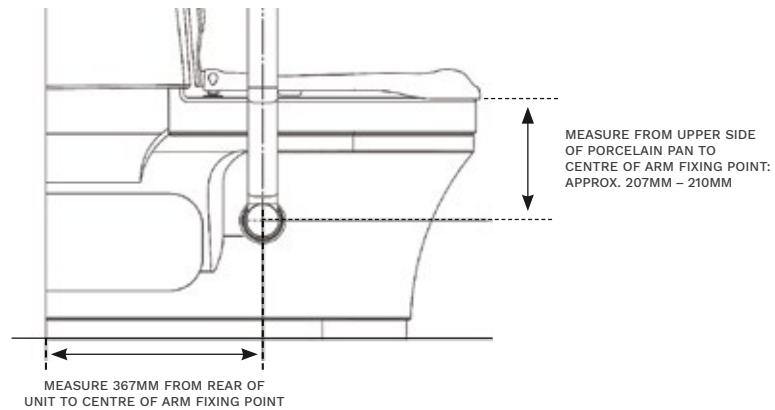

SUPPORT FOOT

LIMA VITA'S SUPPLIED WITH SUPPORT ARMS ARE ALSO SUPPLIED WITH AN ADJUSTABLE STAINLESS STEEL SUPPORT FOOT. IT IS ADVISED THAT THIS IS FITTED AND ADJUSTED TO ENSURE THE TOILET'S STABILITY.

Lima Vita integrated Fold-down Support Arms technical data.

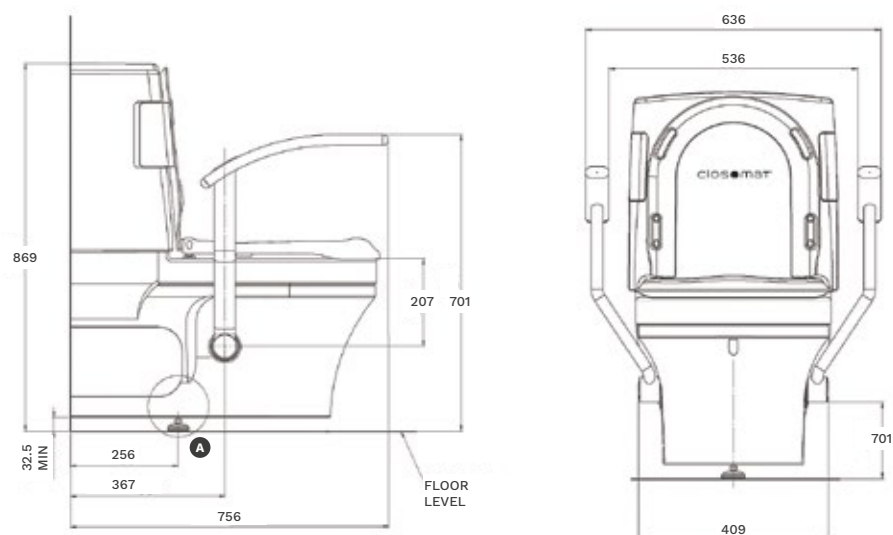

Bariatric

Bariatric Palma Vita

SAFE WORKING LOAD: 362KG/57ST

CLOSOMAT BARIATRIC PALMA VITA
FEATURING THE BIG JOHN SEAT (WHITE PLASTIC)

**PALMA VITA WITH BARIATRIC SEAT:
869MM HIGH X 486MM WIDE X 750MM DEEP**

SEAT DEPTH: 60MM

FLOOR TO TOP OF SEAT: 470MM

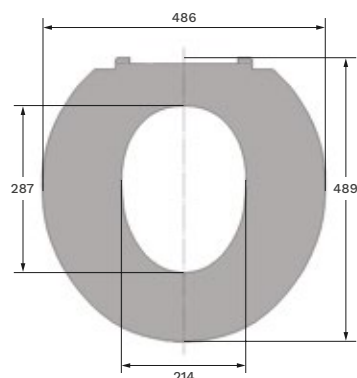

Aerolet Bariatric

SAFE WORKING LOAD: 250KG/39ST

BIG JOHN SEAT (WHITE PLASTIC)

PALMA VITA WITH AEROLET BARIATRIC:
1025MM HIGH X 730MM WIDE X 750MM DEEP

SEAT DEPTH: 60MM

FLOOR TO TOP OF SEAT: 503-588MM

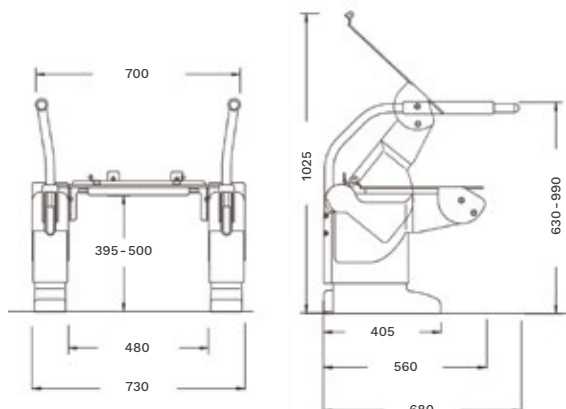

N.B. ONLY TILT VERSION IS AVAILABLE.

Closomat Bench

SAFE WORKING LOAD: 349KG/55ST

OVERALL DIMENSIONS:
530MM HIGH X 600MM WIDE X 510MM DEEP

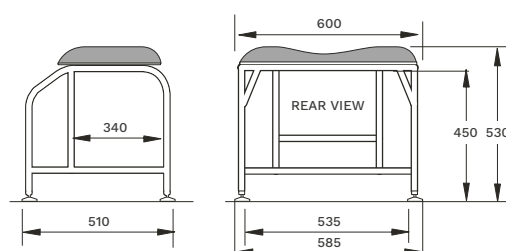

BENCHES TO A HIGHER CAPACITY
AVAILABLE ON REQUEST.

Paediatric support systems

Rifton HTS Hygiene and Toileting System.				
COMPATIBLE WITH CLOSMAT PALMA VITA (SINGLE EXTENDED DOUCHE).				
	UNITS	CLIP-ON	MEDIUM	LARGE
USER HEIGHT	CMS	106-142	106-142	127-188
OVERALL WIDTH	CMS	54	54	60
SEAT (FRONT) TO FOOTBOARD HEIGHT	CMS	25-38	25-38	33-46
SEAT (FRONT) TO FLOOR: MOBILE TILT FRAME	CMS	38-55	38-55	43-57
SEAT (FRONT) TO FLOOR: MOBILE NON-TILT FRAME	CMS	25-38	25-38	33-46
SEAT (FRONT) TO FLOOR: STATIONARY NON-TILT FRAME	CMS	32-43	32-43	38-48
SEAT DEPTH	CMS	29/32/34/37	29/32/34/37	37/39/42/44
SEAT WIDTH	CMS	25/30/36	25/30/36	33/38/43
ARMREST HEIGHT	CMS	18	18	22
BACKREST HEIGHT ABOVE SEAT	CMS	50	50	62
BACKREST WIDTH	CMS	34	34	41
TILT-IN-SPACE PRONE	DEGREES	5°	5°	5°
TILT-IN-SPACE RECLINE	DEGREES	25°	25°	25°
BACKREST ANGLE ADJUSTMENT	DEGREES	6° PRONE, 6° & 18° RECLINE	6° PRONE, 6° & 18° RECLINE	6° PRONE, 6° & 18° RECLINE
FRAME WEIGHT	KG	–	13	20
MAX. CLEAR HEIGHT UNDER SEAT (TILT FRAME)	CMS	–	48	51
SAFE WORKING LOAD	KG	68	68	113

Shower Chair Support Systems

Chiltern AquaMaster A06C

DIMENSIONS	17"	19"	21"
BACKREST WIDTH	445 MM	495 MM	545 MM
CLEARANCE INSIDE FRAME	390 MM	425 MM	490 MM
OVERALL WIDTH	485 MM	520 MM	585 MM

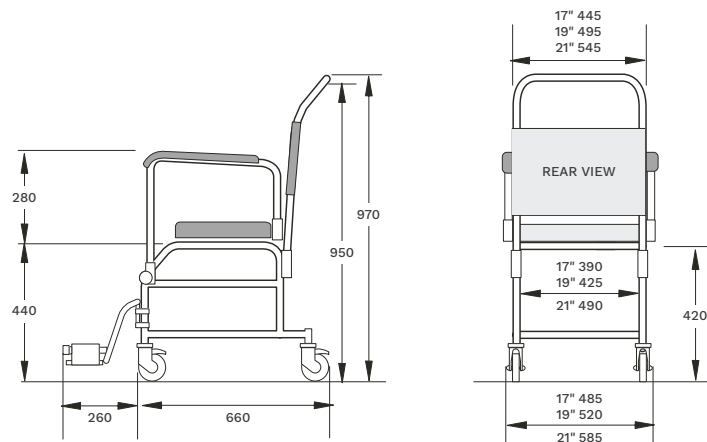

Chiltern AquaMaster A11C

DIMENSIONS	17"	19"	21"
BACKREST WIDTH	445 MM	495 MM	545 MM
CLEARANCE INSIDE FRAME	385 MM	420 MM	485 MM
OVERALL WIDTH	690 MM	725 MM	790 MM

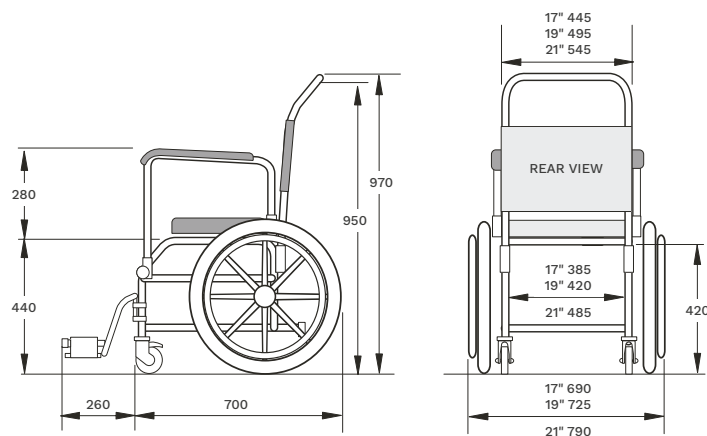

HEIGHT-ADJUSTABLE FROM 440MM
SAFE WORKING LOAD: 200KG/31ST

PRISM T40 AUTO	A	B	C
OVERALL MAXIMUM HEIGHT	1000MM	1000MM	1000MM
OVERALL MAXIMUM WIDTH	590MM	540MM	540MM
LENGTH INCLUDING FOOTRESTS (IF FITTED) AT LOWEST POSITION	1050MM	1050MM	1050MM
LENGTH INCLUDING FOOTRESTS (IF FITTED) AT HIGHEST POSITION	960MM	960MM	960MM
WIDTH OF STANDARD SEAT	540MM	490MM	440MM
HEIGHT TO TOP OF SEAT	560MM	560MM	560MM
HEIGHT CLEARANCE	480MM	480MM	480MM
SEAT DEPTH (STANDARD SEAT)	400MM	400MM	400MM
TOP OF ARMREST TO TOP OF SEAT	180MM	180MM	180MM
WIDTH CLEARANCE	485MM	435MM	385MM
TOP OF BACKREST TO SEAT	450MM	450MM	450MM
DISTANCE BETWEEN ARMRESTS AT REAR	460MM	410MM	410MM
DISTANCE BETWEEN ARMRESTS AT FRONT	530MM	480MM	430MM
SAFE WORKING LOAD: 200KG/31ST	–	–	–

PRISM T70 AUTO	A	B	C
OVERALL MAXIMUM HEIGHT	1000MM	1000MM	1000MM
OVERALL MAXIMUM WIDTH	790MM	740MM	690MM
LENGTH INCLUDING FOOTRESTS (IF FITTED) AT LOWEST POSITION	1140MM	1140MM	1140MM
LENGTH INCLUDING FOOTRESTS (IF FITTED) AT HIGHEST POSITION	1060MM	1060MM	1060MM
WIDTH OF STANDARD SEAT	540MM	490MM	440MM
HEIGHT TO TOP OF SEAT	560MM	560MM	560MM
HEIGHT CLEARANCE	480MM	480MM	480MM
SEAT DEPTH (STANDARD SEAT)	400MM	400MM	400MM
TOP OF ARMREST TO TOP OF SEAT	180MM	180MM	180MM
WIDTH CLEARANCE	485MM	435MM	385MM
TOP OF BACKREST TO SEAT	450MM	450MM	450MM
DISTANCE BETWEEN ARMRESTS AT REAR	460MM	410MM	410MM
DISTANCE BETWEEN ARMRESTS AT FRONT	530MM	480MM	430MM
SAFE WORKING LOAD: 200KG/31ST	–	–	–

Aerolet planning data and service requirements

Aerolet Vertical Palma Vita compatible

SAFE WORKING LOAD

150KG/24ST

OVERALL DIMENSIONS (AEROLET VERTICAL)

1700MM HIGH X 710MM WIDE X 710MM DEEP

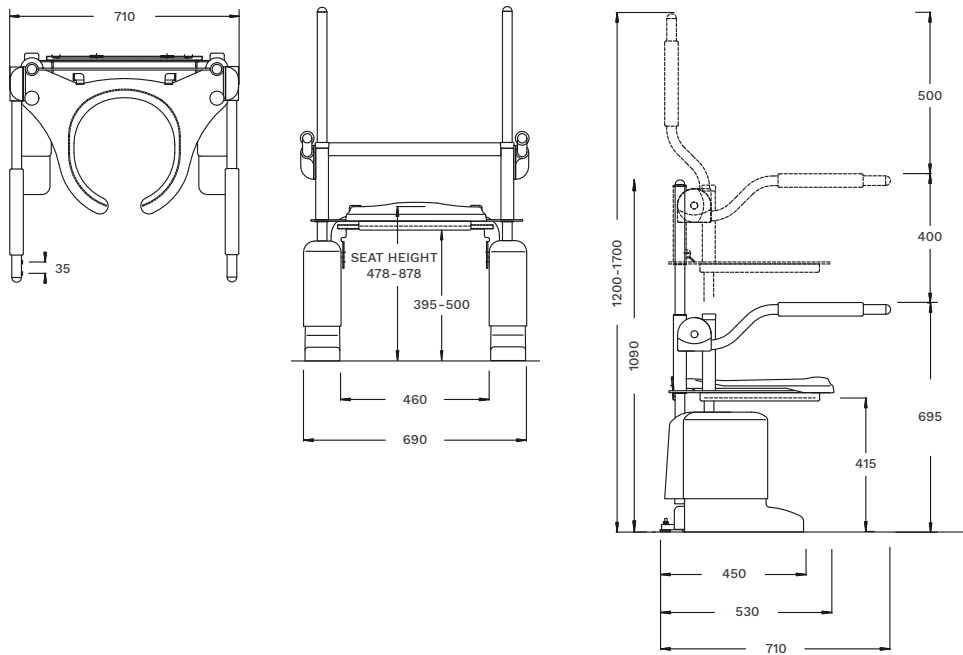

Aerolet Tilt Palma Vita compatible

SAFE WORKING LOAD

150KG/24ST

OVERALL DIMENSIONS (AEROLET TILT)

1025MM HIGH X 730MM WIDE X 680MM DEEP

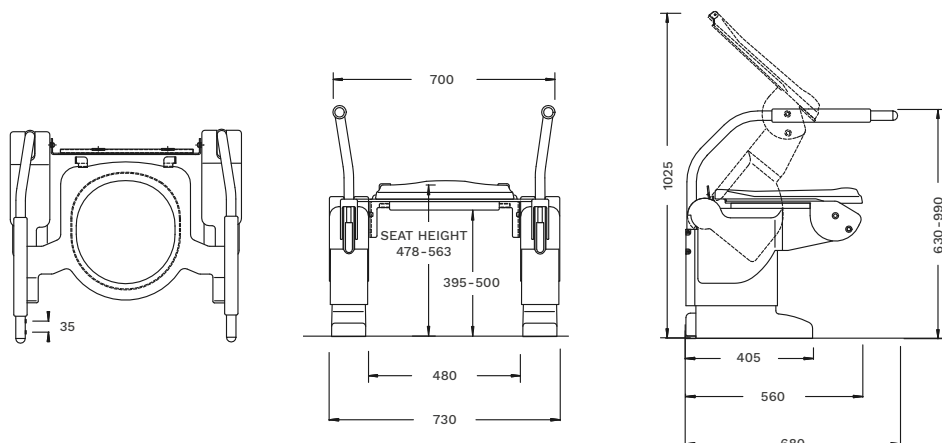

Aerolet planning data and service requirements

Aerolet Conventional

SAFE WORKING LOAD: 150KG/24ST

**FITS MOST EXISTING BATHROOMS:
WIDTH: 67.5CM – HEIGHT: FROM 37CM**

**CAN BE ADJUSTED TO FIT HIGHER BOWLS:
40CM UP TO 50CM**

**CAN BE ADJUSTED TO FIT HANGING BOWLS:
MINIMUM HEIGHT: 37CM**

**OVERALL DIMENSIONS:
1013MM HIGH X 710MM WIDE X 680MM DEEP**

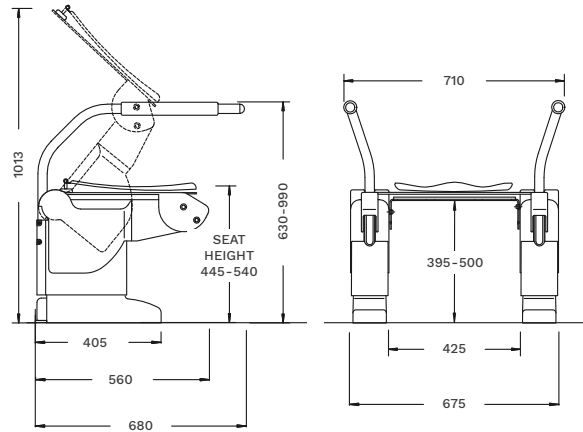

Aerolet Small

SAFE WORKING LOAD: 150KG/24ST

**FITS EVERY EXISTING BATHROOM:
WIDTH: 61.5CM – HEIGHT: 40CM**

**CAN BE ADJUSTED TO FIT HIGHER BOWLS:
40CM UP TO 50CM**

**CAN BE ADJUSTED TO FIT HANGING BOWLS:
MINIMUM HEIGHT: 37CM**

**OVERALL DIMENSIONS:
1013MM HIGH X 650MM WIDE X 680MM DEEP**

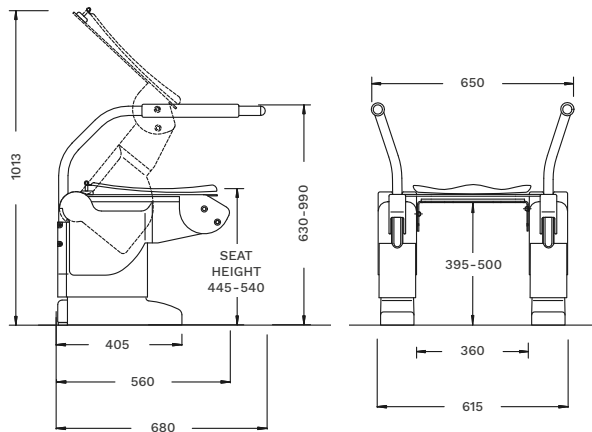

Ceiling Track Hoists

CEILING TRACK HOISTS CAN BE FITTED TO ALMOST ALL LOCATIONS.
TO ACCOMMODATE THIS FLEXIBLE APPROACH, THERE ARE THREE OPTIONS AVAILABLE FOR FITTING:

CEILING MOUNTED

WALL BRACKETS

GANTRY LEGS

SAFE WORKING LOAD: 200KG/31ST

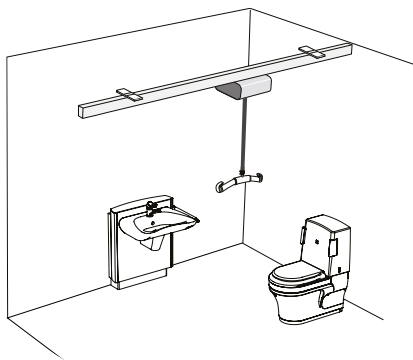

STRAIGHT (SINGLE) TRACK SYSTEM

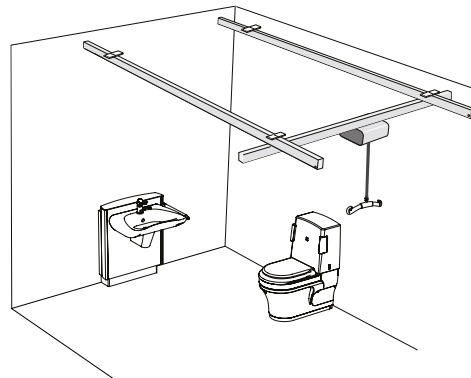

H-TRACK SYSTEM

HOIST MOTOR	24V DC
TRAVERSE MOTOR	24V DC
+ SYSTEM TRAVERSE MOTOR	24V DC
WEIGHT UNLADEN HOIST (POWERED)	22.3 KG
WEIGHT UNLADEN HOIST (MANUAL)	21.9 KG
WEIGHT OF CARRYBAR	2 KG
SHIPPING BOX DIMENSIONS	510MM X 500MM X 500MM
SHIPPING BOX WEIGHT (POWERED)	31 KG
SHIPPING BOX WEIGHT (MANUAL)	28 KG
VOLTAGE	24V DC
FUSE RATING	3AMP MAX
BATTERIES	2 OF 12V 7AMP SEALED – RECHARGEABLE
TRANSFORMER INPUT	240V AC 50HZ
TRANSFORMER OUTPUT	33V AC
APPROXIMATE CHARGING TIME	4 HOURS

Height-adjustable Changing Bench

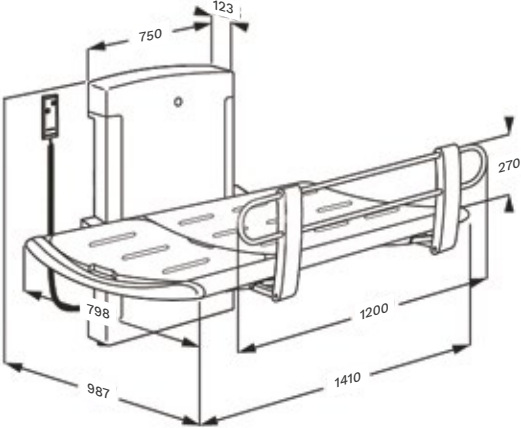
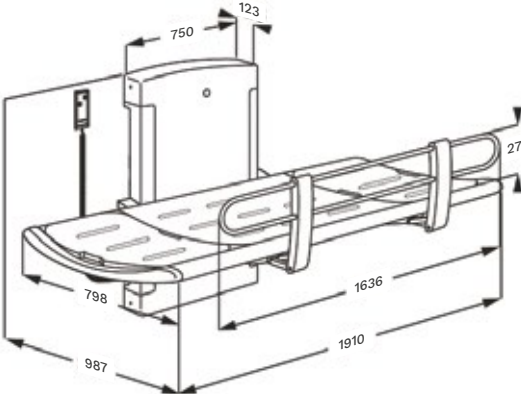
<p>CP CB 3-6: ELECTRICALLY OPERATED 1410MM, COMPLETE WITH SAFETY RAIL.</p>	<p>CP CB 3-6</p>
<p>CP CB 3-7: ELECTRICALLY OPERATED 1910MM, COMPLETE WITH SAFETY RAIL.</p>	
<p>THE WATER COLLECTION TRAY IS EQUIPPED WITH AN INTEGRATED WATER OUTLET THAT PREVENTS WATER FROM SPLASHING ON CARERS, OR THE FLOOR.</p>	
<p>THE INTEGRATED GAS CYLINDER ENABLES THE BENCH TO BE FOLDED EASILY AGAINST THE WALL WHEN NOT IN USE, TO MAXIMISE FLOOR SPACE.</p>	
<p>THE FLEXIBLE HOSE CAN BE CONNECTED TO EITHER AN OUTLET IN THE FLOOR, OR ON THE WALL.</p>	
<p>THE SAFETY RAIL CAN BE FOLDED EASILY UP OR DOWN USING ONLY ONE HAND.</p>	
<p>ALUMINIUM, POLYURETHANE FOAM, PLASTICS, POWDER-LACQUERED STEEL.</p>	<p>CP CB 3-7</p>
<p>HEIGHT-ADJUSTABLE 700MM.</p>	
<p>MAXIMUM LOAD: 200KG</p>	
<p>SAFE WORKING LOAD: 200KG/31ST</p>	

Height-adjustable Hand Wash Basin

Brackets (electric or gas)

POWERED WASH BASIN LIFTER, 300MM HEIGHT-ADJUSTABLE WITH LEVER CONTROL. THE LEVER CONTROL IS MOUNTED AT THE END OF A FIXED RAIL WHICH CAN PROVIDE SUPPORT AND FUNCTION AS A TOWEL RAIL. THE WASH BASIN CAN BE MOVED UP AND DOWN BY MEANS OF THE LEVER CONTROL ALONE. A WIRED HAND CONTROL CAN ALSO BE SPECIFIED.

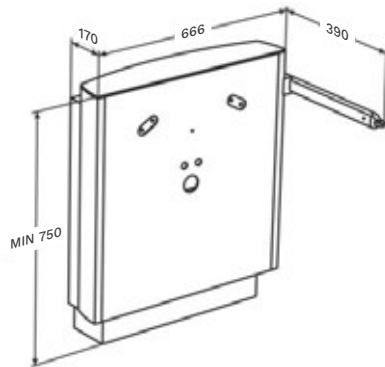

CONCEALED PLUMBING (ELECTRIC ONLY)

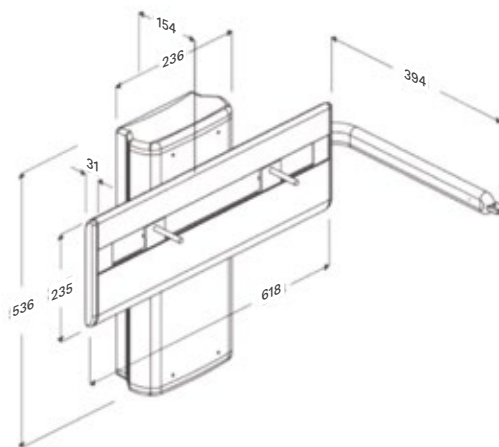

EXPOSED PLUMBING

Basin

THE CONCAVE FRONT EDGE STABILISES A STANDING AS WELL AS A SEATED USER. THE ROUNDED SHAPES ARE NICE TO GRIP AND LEAN AGAINST. THE DESIGN OF THE CORNERS LEAVES SPACE AND SUPPORTS THE ELBOWS IN THE BASIN AND THE FLAT BOTTOM LEAVES SPACE FOR THE LEGS OF A SEATED USER. CERAMIC.

SAFE WORKING LOAD: 100KG/15ST

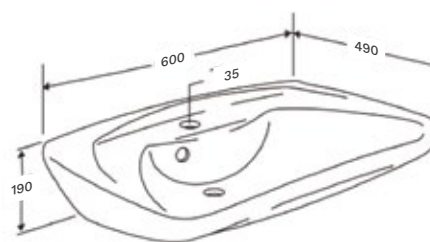

Height-adjustable Hand Wash Basin

Feed and Waste systems

FLEXIBLE FEED/WASTE SYSTEM AVAILABLE IN THE FOLLOWING SIZES:

500MM/700MM

700MM/700MM

700MM/900MM

1200MM/1500MM

FLEXIBLE FEED/WASTE SYSTEM FOR THE UK:

FEED PIPES: 700MM

WASTE PIPES: 700MM

FEED PIPE, METAL BRAID WITH 1/2" COUPLING

FLEXIBLE WASTE PIPE, DIAMETER: 32MM

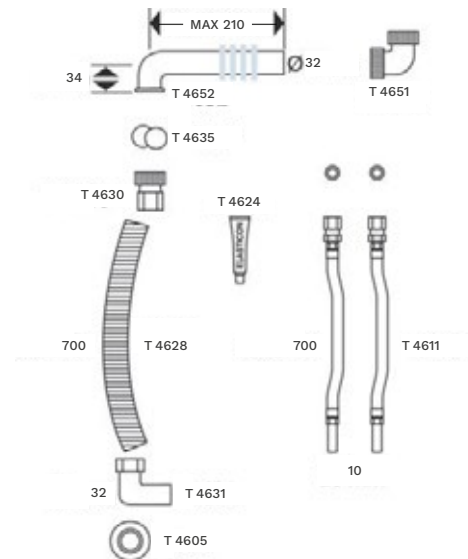

Tap

TMV3 THERMOSTATIC SEQUENTIAL LEVER MIXER TAP. A TMV3 TAP FEATURING ANTI-SCALD TECHNOLOGY, A SAFE TOUCH BODY AND A SELF-DRAINING SPOUT. WITH COPPER INLET TAILS. WITHOUT DRAIN FITTING. WRAS APPROVED.

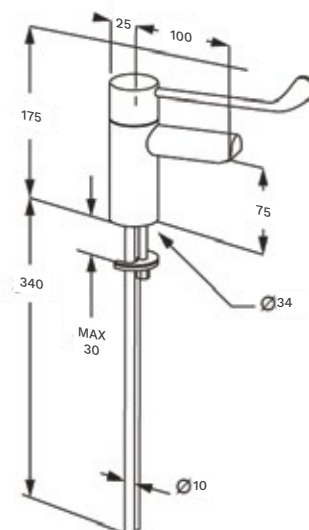

More information on Hand Wash Basins is available on our website: closomat.co.uk

The Shower Area

Aerolet Tilting Shower Seat

SAFE WORKING LOAD: 150KG/24ST

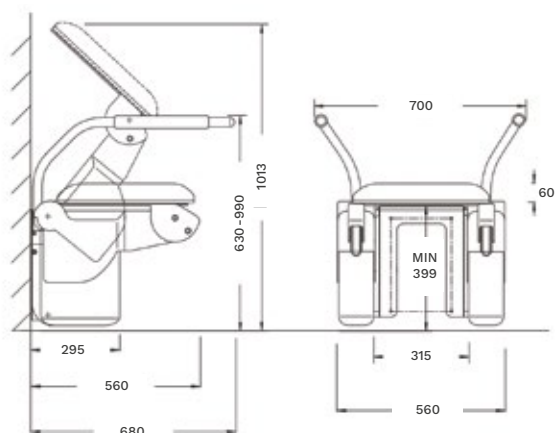

Aerolet Vertical Shower Lift

SAFE WORKING LOAD: 190KG/30ST

**POWER SUPPLY VIA CONTROL BOX MOUNTED
IN ACCORDANCE WITH PART P.**

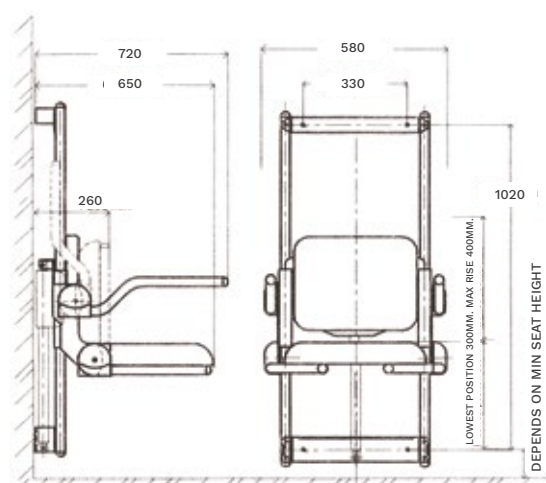

iDry Body Dryer

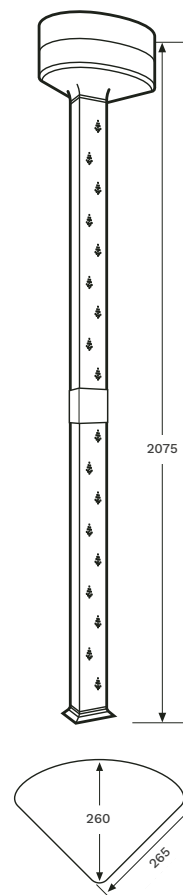

Height-adjustable Shower Seat

SAFE WORKING LOAD: 150KG/24ST

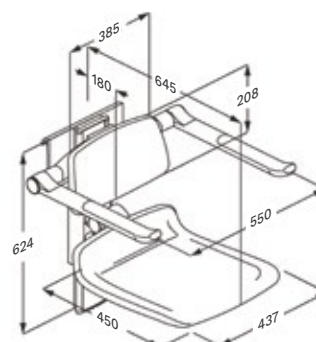



Closomat Care. Our Promise to you.

From the design and manufacture of our wash and dry toilets, to how they are installed, serviced and maintained, we are there to ensure that our products continue to play an essential role for our customers for many years. It's what we call **Closomat Care**.



Made in Britain

We're proud to say that we still design and manufacture our toilets in the North West of England and have done so for more than four decades. In fact we're the UK's only specialist toilet manufacturer to employ British know-how and craftsmanship.



Our own service engineers

We don't contract out to just anyone. Our in-house engineers are trained by us – the manufacturer – so they know our products better than anyone else. They are specialists not just in wash and dry toilets, but in Closomat wash and dry toilets so you can be assured that your toilet is being looked after by an expert to ensure everything is as it should be.



No Quibble installation guarantee

We offer an expert installation service with a no quibble guarantee. This means that no matter how complex the job, the price will not change. Once installed, a follow-up customer care visit checks that everything is okay and provides the opportunity for the customer to ask questions or request minor adjustments. This gives everyone complete peace of mind.



Customisable, flexible, fit for the future

Our wash and dry toilets can be customised in literally thousands of ways to ensure the perfect toileting solution for either simple or complex needs. We have also created a carefully selected range of accessories which further enhance toileting – from handles and supports to moving and handling aids – which can be specified depending on individual needs.

And on top of that, as the needs of the user change, the toilet can be modified and adjusted removing the possibility of having to buy a new toilet.



Watertight servicing and warranty

If you have ever had a car, you'll know that as well as a warranty, you also need to have it serviced at regular intervals. A service gives you the peace of mind of knowing that everything is okay, and it can also spot any potential issues before they become a big problem.

Well, it's the same with Closomat wash and dry toilets. A warranty is there for when things go wrong. And an annual service visit gives the added peace of mind that the toilet is working correctly and will continue to do so. We know how important a wash and dry toilet is so we want to ensure that it never lets you down.

Closomat Limited

Building 1, Brooklands Place,
Brooklands Road,
Sale, Cheshire, M33 3SD

Freephone: 0800 374 076

Telephone: 0161 969 1199

Fax: 0161 973 2711

General Enquiries: info@closomat.co.uk

Sales Orders/Enquiries: sales@closomat.co.uk

Quotations/Pricing: quotations@closomat.co.uk



DESIGNED AND BUILT IN BRITAIN

MMS Medical Cork

51 Eastgate Drive,
Little Island,
Cork, T45 EA06

Telephone: 021 461 8000

info@mmsmedical.ie or visit mmsmedical.ie

MMS Medical Dublin

Unit 81, Western Parkway Business Park,
Lower Ballymount Road,
Dublin 12, D12 EY92

Telephone: 01 450 0582

info@mmsmedical.ie or visit mmsmedical.ie



We reserve the right to make modifications as a result of ongoing adjustments and further development. This factor, and the variety of equipment options available, may result in descriptions not corresponding to the current equipment version in all details.

CLOSOMAT® has been the protected trademark of the world's first Wash and Dry (shower) toilet since 1957.

